

\$4,500,000

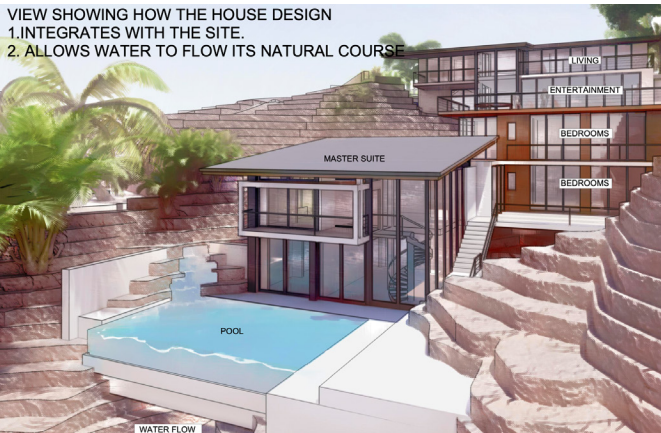

## OCEANFRONT AT 3 POIPU

Honolulu, Oahu | 35,155 SQFT Land  
MLS# 202421776 | \$4,500,000

A rare opportunity to build your custom oceanfront estate in Honolulu's coveted Portlock neighborhood. This expansive south facing 35,155 square foot lot offering unparalleled privacy and security, with breathtaking panoramic views of Maunalua Bay with occasional turtles, dolphins, and whales in the winter. Approved architectural plans are available for building over 11k sqft multilevel modern residential home, showcasing a luxurious design that maximizes the site's potential by utilizing its natural beauty and topography to preserve the land and the environment. This is more than just a property; it's a prestige unique moment to build your own oceanfront masterpiece.



Christine MyHanh Bondroff

President/CEO/Principal Broker  
(R, CRS) RB-19520  
Honolulu Hawaii Realty  
808.352.6678  
christine@besthawaiihomes.com  
www.besthawaiihomes.com

